

Tool & Die Design/Engineering

Tool Room

- CNC Machining
- Wire EDM
- Fixturing
- Grinding
- Precision Die Assembly

Tool Room Equipment

- Fully equipped machining center
- Agie EDM
- Toyoda CNC Machining Center

Dies Produced

- Compound
- Progressive
- Notching
- Forming
- Shallow Draw

Die Material

- Carbide
- High Speed Steel
- A2, D2

Engineering

- CAD 2D, 3DQuickpress, and SolidWorks programs
- On-site Support and Analysis
- Reverse Engineering
- Product Development Consultation

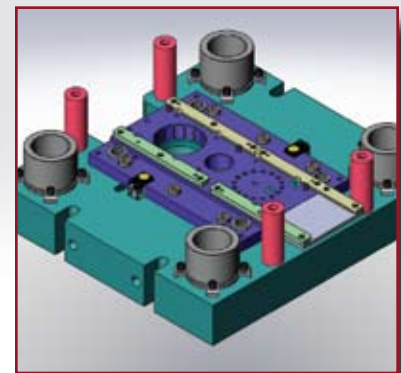
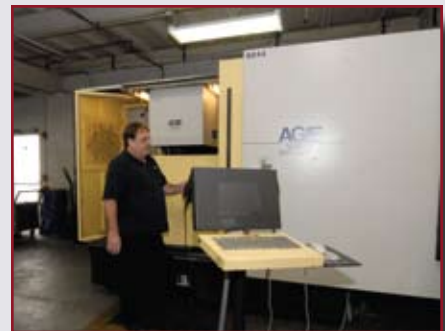

8050 Austin Avenue • Morton Grove, Illinois 60053
800-486-4756 • F. 847-966-0322
www.skodie.com